



# PSP

## PUMP PRESSURE SWITCH

**Electrical:**  
20 A 12/24 VDC—125VAC

12 A 250 VAC

**Protection:**  
Plastic cover straight through wiring captive cover screw  
Rubber Grommet

**Temperature Range:**  
-25C to +85 C

**Mechanical Life:**  
1,000,000 Plus Cycles

**Diaphragm Materials:**  
Nitrile (Optional Viton or EPDM)

**Housing Material:**  
Steel or Stainless Steel

**Max overpressure:**  
350 PSI (25 BAR)

**Weight:**  
1.5 lbs (0.45 kg)

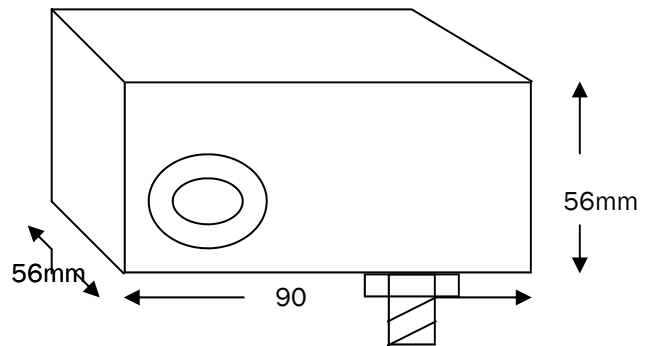

Range	Adjustment
1	35– 150 PSI (2.3 - 10 BAR)
Differential	30–40 PSI (2–3 bar)

**How to Order:**

PSP — 1— 4G— A— BH

<p><b>PSP</b></p>	<p>( Adjustment range) Above</p>	<p><b>4G</b> 1/4" Bsp <b>4M</b> 1/4" Npt</p>	<p><b>A</b> N.O. <b>BH</b> BOX Housing</p>	<p>Options Blank Standard <b>1.</b> Viton <b>2.</b> EPDM <b>3.</b> St St</p>
-------------------	--------------------------------------	--	--	--

Other options by request