

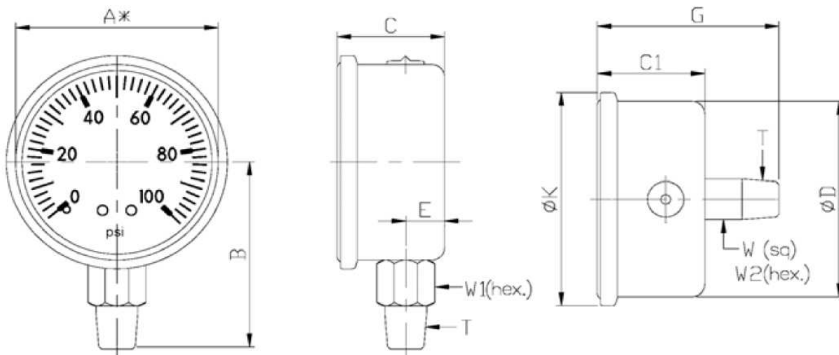

BPG Pressure Gauges

Liquid Filled General Purpose Pressure Gauge

Case and bezel material:	304 stainless steel, liquid filled with vent plug
Connection:	Copper alloy
Bourdon tube material:	Copper alloy
Working temperature:	Ambient = -20~60oC, Process = +70oC
Dial:	Black print (kPa) red print (PSI) on white background
Ranges:	-100~0 kPa to dual scale 0~40000 kPa/PSI
Connection:	1/4" BSP for 63 mm, 3/8" BSPT for 100 mm
Surge Protection:	Available on request
Window:	Polycarbonate
Movement:	Copper alloy
Pointer:	Aluminium black finish
Accuracy:	+/- 2.5% of full scale



Dimensions in mm

	A*	B	C	C1	D	E	G	K	T	W1	W2
63	62.2	54.5	30.0	30.5	60.8	10.0	58.8	68.8	1/4" BSPT	14.0	14.0
100	96.5	78.5	32.0	34.3	98.7	9.8	73.0	104.0	3/8" BSPT	22.0	21.0

BPG2 **B** > **LM** > **10B** > **D** > **L**

Size mm Internals Connection Pressure Range Style Options

63 mm = 2 Brass = B Back = CB duel Scale =D D = Direct Mount L= Liquid Filled

100 mm = 4 St St = S Bottum = LM P = Panel Mount

S= Snubber

State max pressure Range